

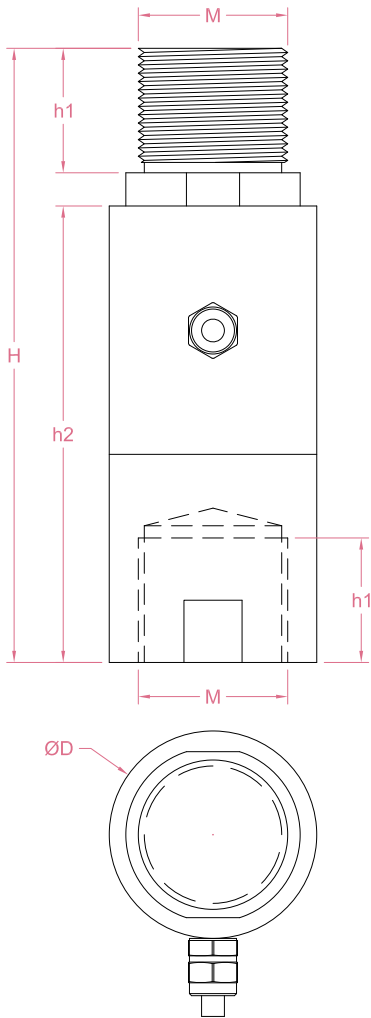

Dimensions in "mm"



Order example:

**2 x LCRB - 20kN - M**

Quantity    Model    Capacity    M16  
M20  
M27  
M36

Email to [sales@loadcellsensor.com](mailto:sales@loadcellsensor.com) for a quote

Capacity	D	H	h2	h1	M
1/2/5/10/20kN	38	94	64	20	M16*1.5
2/5/10/20/30/50kN	38	108	69.6	25.4	M20*1.5
5/10/20/30/50/100kN	45	139	92	35	M27*2
20/30/50/100/150/200kN	50	172	115	45	M36*2



Customization options

Dimensions and measuring range
IP rating up to IP68
Working Temperature (-40°C...+150°C)

Specifications			
Rated Capacity	1/2/5/10/20/30/50/100/150/200 kN		
Rated Output	1.5 mV/V	Compensated Temp.	0...+40°C
Excitation	3~15V	Operating Temp.	-20...+60°C
Zero Balance	±0.05 mV/V	Temp. Coeff. of Zero	±0.02% F.S./°C
Nonlinearity	±0.5% F.S.	Temp. Coeff. of Span	±0.02% F.S./°C
Hysteresis	±0.5% F.S.	Input Resistance	700/350±100 Ohms
Nonrepeatability	±0.2% F.S.	Output Resistance	700/350±50 Ohms
Creep(5min)	±0.1% F.S.	Insulation Resistance	>2000M Ohms(50V)
Safe Load Limit	150% F.S.	IP Rating	IP62
Breaking Load	200% F.S.	Element Material	Stainless steel
Cable	Ø5*3000mm 4-conductor shielded cable		

• LCS reserves the right to modify its design and specifications without notice

